

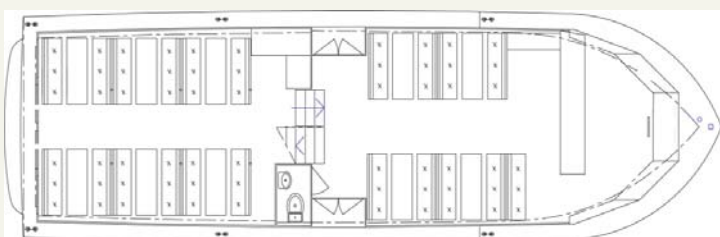

M/S Victoria

Cosy wooden vessel



- Dining capacity 60 persons; dining lounges for 24 and 36 persons
- Sun deck for 50 persons
- Responsibly sourced food; we follow the WWF sustainable seafood guidelines
- Firm fittings
- Bar in the dining lounge
- Fully licenced
- Length 15 m - width 5 m
- Loudspeakers in all premises
- Electricity 220V
- Microphone
- CD player / MP3
- One toilet

Prices

Rates on weekdays

2h	3h	additional hours
1295 €	1540 €	245 €

Prices include VAT 10 %

STROMMA

Strömma Finland Oy Ab | tel. +358 (0)9 2288 1222
sales@stromma.fi | www.stromma.fi